

LEGEND

-  BLUE LOTS
(1-4, 5-35, A-1, B, & 107-108)
-  GREEN LOTS
(99-102, & 103-106)
-  YELLOW LOTS
(36-50, 52-75, 109-110, & SANDY LANE HPR UNITS)
-  RED LOTS
(76-98, & 112)
-  PURPLE LOT
(LOT B FOUNDER'S COTTAGE aka SEA OAK MANOR)

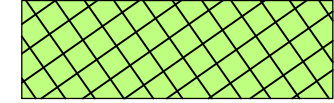
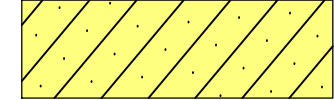
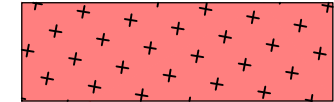
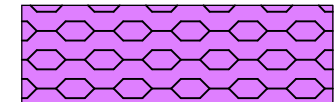
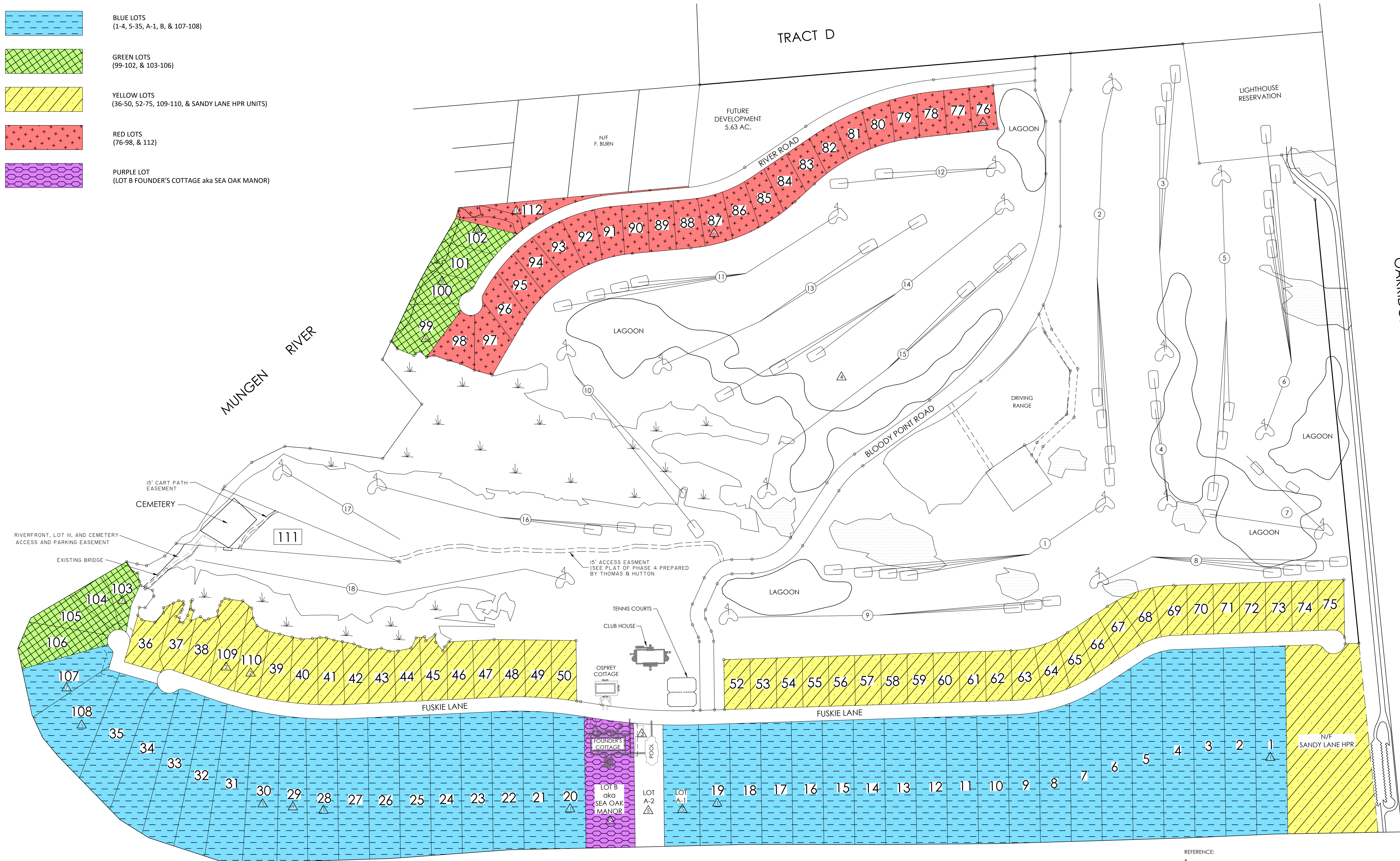

OAKRIDGE PLANTATION

CALIBOGUE SOUND

- REFERENCE:**
- ▲ Daufuskie Island Club Phase I, PB 37, Pg.12, dated 04/26/1989
 - ▲ A Plat of Phase III Lots 109-110 (1/4/3 Parcel F), PB 59, Pg. 102, dated 02/11/1997
 - ▲ Parking Easement Lots B & A2, PB 951, Pg. 1069, dated 02/12/1997
 - ▲ A Plat of Bloody Point Golf Course & Facilities, PB 61, Pg. 5, dated 06/16/1997
 - ▲ Lot B and Lots A1 and A2 of Subdivision of Lot A of the Founders Cottage Tract, PB 61, Pg. 6, dated 06/16/1997
 - ▲ A Plat of Phase II Lots 76-99 River Rd., PB 62, Pg. 14, dated 09/16/1997
 - ▲ A Plat of Phase III Lots 103-107 (1/4/3 Parcel C) (w/ cemetery), PB 62, Pg. 15, dated 09/16/1997
 - ▲ A plat of Phase III Lots (1/4/3 Parcel B) Lots 100, 101, and 102 River Rd., PB 62, Pg. 100, dated 10/13/1997
 - ▲ Lot 29, Fuskie Lane, PB 100, Pg. 17, dated 06/19/2004
 - ▲ Boundary Plat Remainder of Parcel B (40 River Road - Owned by McCarthy), PB 137, Pg. 20, dated 06/27/2013

**MASTER SITE PLAN
EXHIBIT
BLOODY POINT**

DAUFUSKIE ISLAND, SOUTH CAROLINA

PREPARED FOR:
BLOODY POINT PROPERTY OWNERS' ASSOCIATION, INC.

PREPARED BY:
THOMAS & HUTTON

50 Park of Commerce Way
Savannah, GA 31405 • 912.234.5300
www.thomasandhutton.com

JOB NO: J-28402.0000	DATE: 9/21/2020
DRAWN: JBJ	SCALE: 1" = 200'
REVIEWED: SKM	SHEET: 1 of 1